

295 EASTERN AVENUE
295 EASTERN AVENUE, LLC
CHELSEA, MA

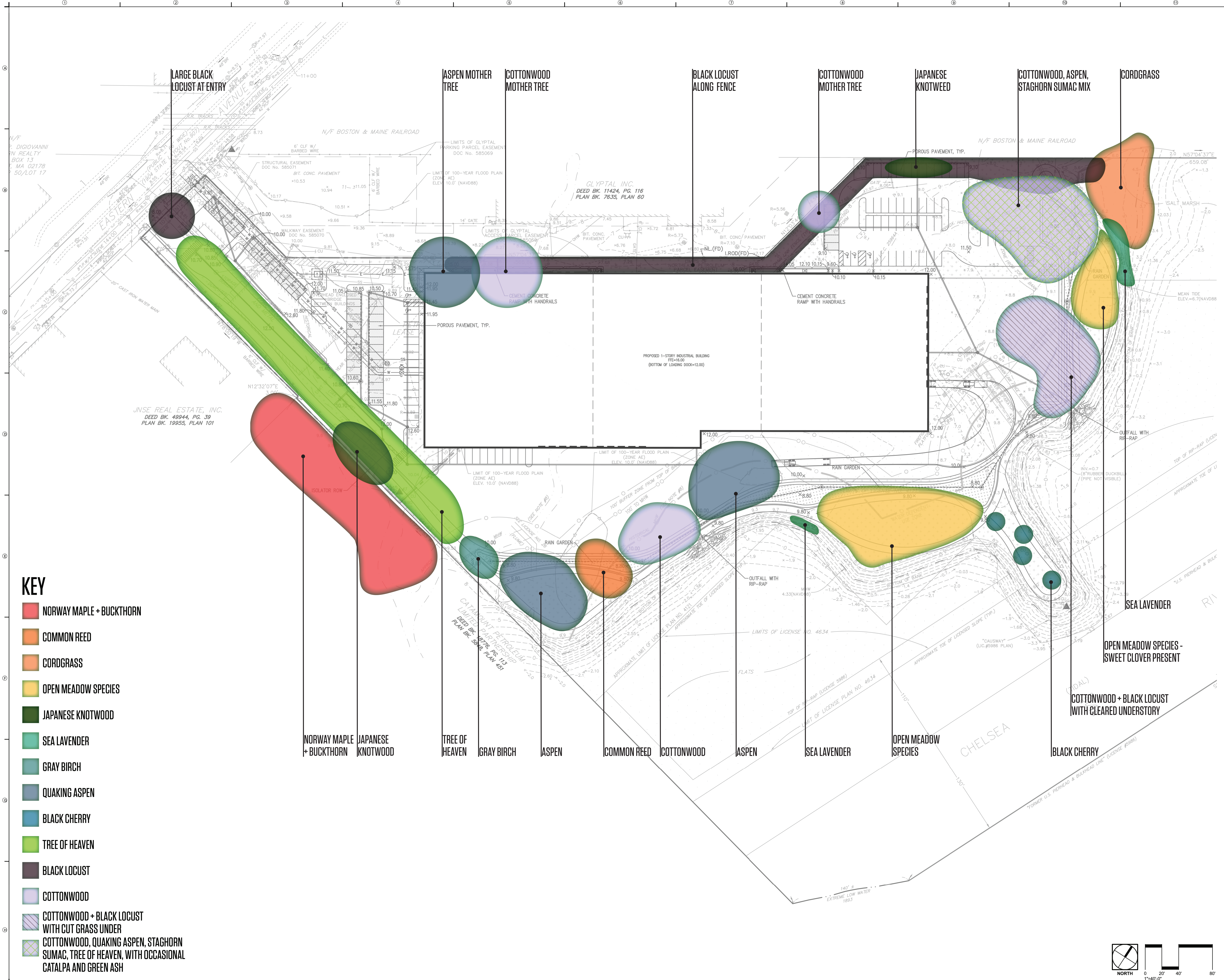

- KEY**
- NORWAY MAPLE + BUCKTHORN
 - COMMON REED
 - CORDGRASS
 - OPEN MEADOW SPECIES
 - JAPANESE KNOTWOOD
 - SEA LAVENDER
 - GRAY BIRCH
 - QUAKING ASPEN
 - BLACK CHERRY
 - TREE OF HEAVEN
 - BLACK LOCUST
 - COTTONWOOD
 - COTTONWOOD + BLACK LOCUST WITH CUT GRASS UNDER
 - COTTONWOOD, QUAKING ASPEN, STAGHORN SUMAC, TREE OF HEAVEN, WITH OCCASIONAL CATALPA AND GREEN ASH

NORWAY MAPLE + BUCKTHORN JAPANESE KNOTWOOD TREE OF HEAVEN GRAY BIRCH ASPEN COMMON REED COTTONWOOD ASPEN SEA LAVENDER OPEN MEADOW SPECIES BLACK CHERRY

SEA LAVENDER
OPEN MEADOW SPECIES - SWEET CLOVER PRESENT
COTTONWOOD + BLACK LOCUST WITH CLEARED UNDERSTORY

ISSUE DATE: _____
REVISIONS

#	DATE	DESCRIPTION

DRAWN: _____ REVIEWED: _____

EXISTING VEGETATION DIAGRAM

PROJECT NUMBER: 0000

SHEET NUMBER

